

ENDOtube
FOR WASH BOTTLE



1. Open Pack. Remove tubing and record date and time on removable sticker.



2. Insert siphon into sterile water bottle, tighten cap.

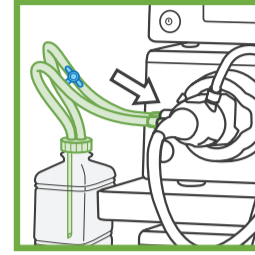

3. Ensure clamp is open and attach tubing to endoscope's air/water port. If using Room Air Only set, continue to Step 6.

ENDOtube
FOR INSUFFLATION

WHEN USING THE COMBINED AIR/CO₂ INSUFFLATION SET

FOLLOW STEPS 4A OR 4B+5. A SEPARATE INSUFFLATION TUBING SET IS NEEDED FOR CO₂ INSUFFLATION.

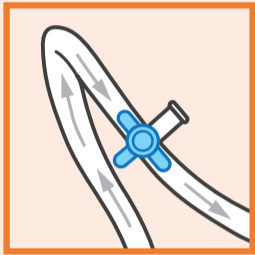

Room Air Insufflation

- 4a. Ensure blue stopcock on ENDOtube for Wash Bottle is turned so air can circulate from water bottle to endoscope. Continue on to Step 6.

OR

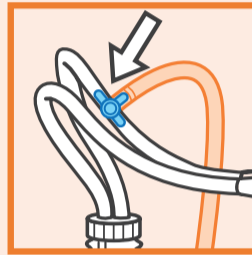

CO₂ Insufflation

- 4b. Open ENDOtube for Insufflation and remove tubing. Connect to Wash Bottle tubing and to the CO₂ insufflator. Turn on light source followed by insufflator.

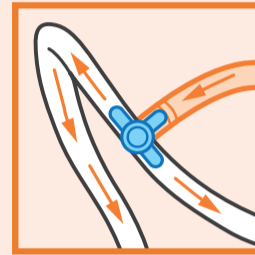

CO₂ Insufflation

5. Turn off endoscope's airpump and ensure blue stopcock on ENDOtube for Wash Bottle is turned so that CO₂ can circulate from the insufflator to the endoscope and water bottle.



6. Ensure the system is working by priming the appropriate port channel (Air/H₂O or CO₂/H₂O). Ensure all connections are secure, tubing not kinked and siphon is submerged in sterile water.



7. Go back to Step 4-5 if the source of insufflation needs to be changed during the procedure.

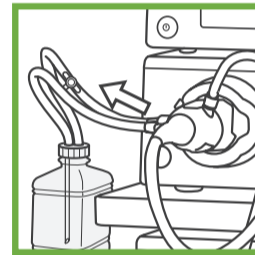

8. After 24 hour use, clamp and disconnect tubing before the processor and insufflator are turned off.

ENDOtube
FOR WASH PUMP



1. Open Pack. Remove tubing and record date and time on removable sticker.
2. Insert siphon into sterile water bottle, tighten cap.

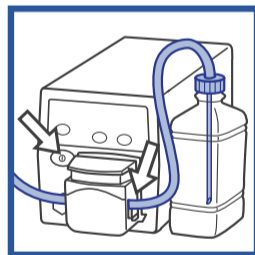

3. Open pump head. Insert tubing between markers and close head.
4. Turn on pump and prime system.

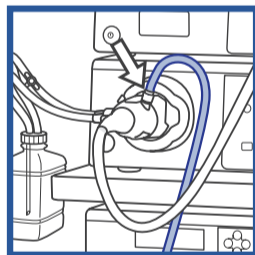

5. If using Single Use Connector, continue to Step 6. Otherwise, connect ENDOtube for Wash Pump to water jet port (or biopsy valve) on endoscope.

SINGLE USE CONNECTOR

OPTIONAL

WHEN USING SINGLE USE, ONE-WAY WATER JET CONNECTOR FOLLOW STEPS 1-4 ABOVE AND THEN CONTINUE WITH STEP 6, OTHERWISE CONTINUE WITH STEP 9.

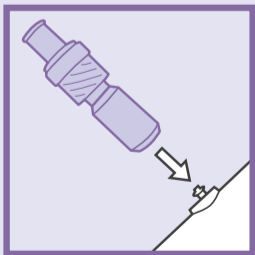

6. Open pack and remove Single Use Connector. Attach connector to water jet port (or biopsy valve) and tighten.

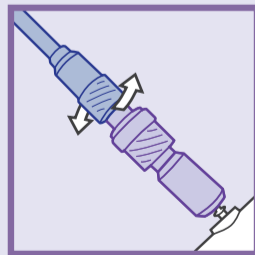

7. Attach ENDOtube for wash pump to Single Use Connector and prime system.

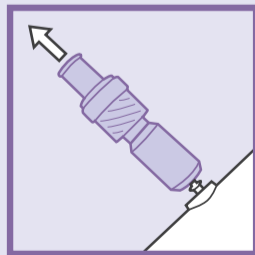

8. Single Use Connector can temporarily be left on, to aid with flushing of endoscope after the procedure.

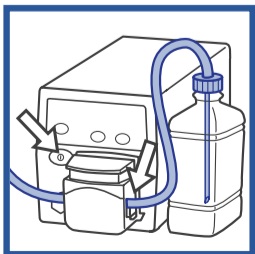

9. After 24 hour use, turn off pump and disconnect ENDOtube for wash pump tubing.

STOPCOCK QUICK REFERENCE GUIDE

3-WAY STOPCOCK POSITIONING FOR COMBINED AIR/CO₂ SETS.

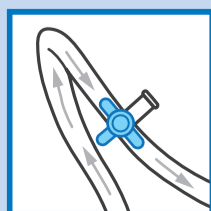

ROOM AIR INSUFFLATION

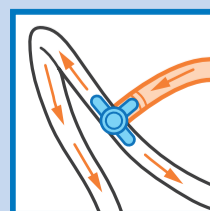

OLYMPUS CO₂ INSUFFLATION

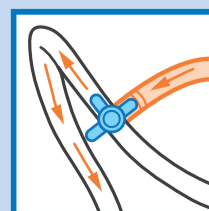

PENTAX CO₂ INSUFFLATION